

**QUICK POSSESSION (1923-LC)**  
**1123 - 28 Street NW**  
**Edmonton**  
**\$373,900 Highclere Craftsman**

1,669 Sq Ft | 3 Bedrooms | 2.5 Bathrooms

Carpet    Laminate    LVL



Craftsman

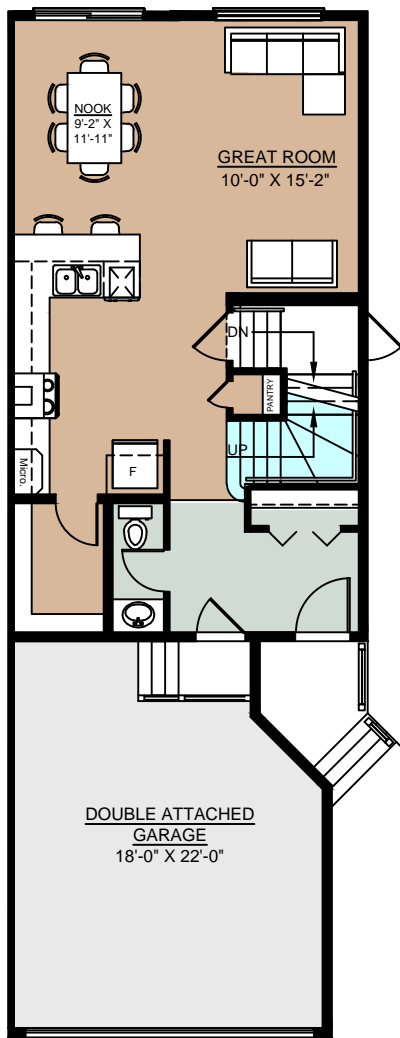

Main Floor 688 Sq Ft

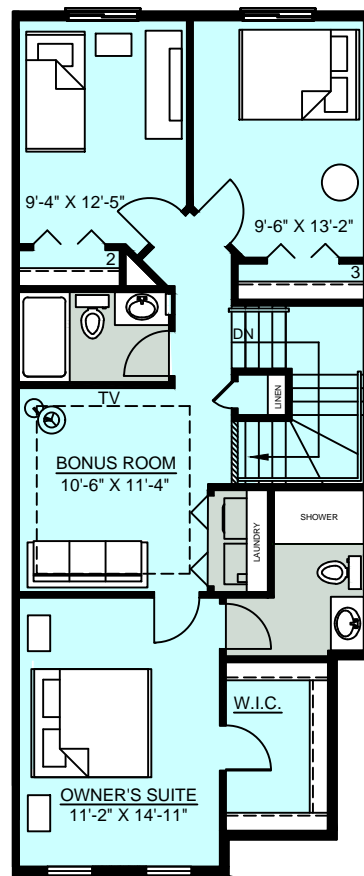

Upper Floor 781 Sq Ft

Artist's rendition may be different than actual home

Dec 17/18

